

Safe Biking and Healthy Environments



First Avenue Bike Trail Park

Malvern Borough is planning a Bike Trail Park on an 0.8-acre parcel inside the bend of the Malvern Fire Company access drive. This project will provide a safe biking area for Malvern's youth, while preserving the tree canopy and enhancing native habitat.

Mountain biking is an increasingly popular sport, especially among local middle and high school students. The trails will incorporate bumps and curves to encourage physical activity. A [preliminary design](#) provides 1,114 feet (0.21 miles) of trails, including an expert area (800 feet), beginner area (190 feet), and starting loop (124 feet). The final design will be completed by the Borough Engineer in consultation with a professional bike park builder.

An arborist / urban forester is preparing a report on the trees, vegetation, and existing conditions. The ecology of the parcel will be improved by removing debris and invasive understory, while planting native species to buffer the neighboring properties and the areas between the bike trails. Trees will only be removed if they present a safety issue.

The site will be fenced and follow standard operating hours, dawn to dusk. Access will be via a new sidewalk that is already planned as part of a new entrance to the Randolph Woods Nature Preserve. A signal light warning system, operated by the Malvern Fire Company, is proposed to ensure pedestrian safety along the access drive.

This project is supported by a \$91,677 grant from Chester County, awarded in 2021. It was originally proposed in 2020 as a "pump track," and Borough Council now proposes to revise the plan to maintain the tree canopy and provide a more natural setting for riders. The terms of the grant require the parcel to be permanently designated for publicly accessible open space, park, or recreational use.

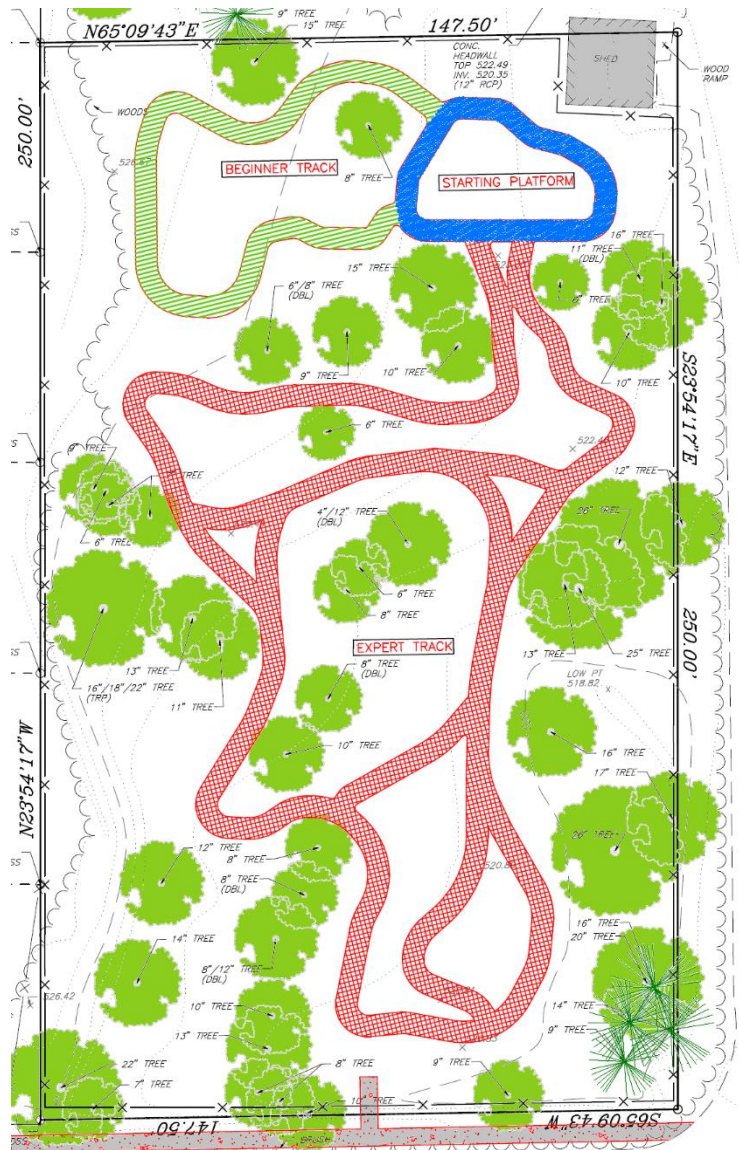

**This preliminary design provides
1,114 feet (0.21 miles) of bike trails
amongst the existing tree canopy.**

Open Space and Recreation in Malvern Borough

The [2022 Comprehensive Plan](#) notes that Malvern Borough has almost 17% of its total land area in open space uses, which is highest amongst Chester County's fifteen boroughs and comparable to many more rural communities.

Nonetheless, the Borough is only 1.3 square miles, and available space for new active recreation projects is limited. Our largest areas are preserved for conservation and passive recreation. The map and table below provide a complete inventory of Borough-owned property. Note that the Borough does not own the 22-acre Paoli Memorial Grounds.

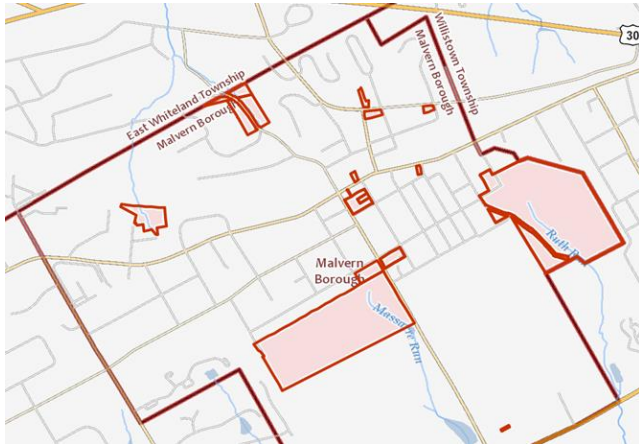

Site	Acres	Contents
Paoli Battlefield	40.0	Historic site
Randolph Woods	38.2	Nature preserve easement
N Warren Ave	5.3	Very steep slopes, stream
*Public Works Area	4.8	Municipal uses, Comcast
110 Crestside Way	3.5	Pump station, steep slopes
*Burke Park	1.7	Community park
*Quann Park	1.4	Basketball, softball
Borough Hall	1.1	Municipal building
*Herzak Park	0.4	Basketball court
209 Old Lincoln Hwy	0.4	Very steep slopes
*Rubino Park	0.3	Playground
King St Lot	0.2	Parking lot
Church St Lot	0.2	Parking lot
Paoli Pk/S Warren Av	0.1	Small landlocked parcel

The Borough owns nearly 100 acres of property, much of which is preserved open space. Sites suitable for active recreation are shown with an asterisk.

The Borough has considered other locations for the bike park, including the field to the east of the Malvern Fire Company access drive, referred to by some as "Option B." This location is part of the Randolph Woods Nature Preserve easement area because it slopes directly downward to Ruth's Run, an important headwater of the Crum Creek. The [2020 Randolph Woods Master Plan](#) identified this field as part of the Water Resource Protection Area and recommended that the lawn be converted to meadow. It is not a suitable location for a bike park.



The Randolph Woods Master Plan recommends biking in the isolated parcel west of the access drive, and meadow plantings in the Water Resource Protection Area to the east.