

East Whiteland Township Park & Recreation Plan

Map 7

PUBLICLY ACCESSIBLE RECREATION SITES

- TOWNSHIP - OWNED SITES**
- COMMUNITY PARKS**
1. Conestoga Trail Soccer Field (Township Bldg.)
 2. Swanenburg Property
 3. Battle of the Clouds Park
 4. Valley Creek Park
- NEIGHBORHOOD PARKS**
5. Whiteland Farm Park
 6. Down East Park
 7. Spring Mill Farms Park
- TOT LOTS**
8. Bryn Erin @ Kelmar
 9. Bryn Erin @ Markel
- NATURE PRESERVES**
10. Ecology Park
- OPEN SPACES**
11. Chester Valley Knoll
 12. Oakhill Circle
 13. Brooklands
 14. Glenoch Way
 15. Bryn Erin Moores Road Basin
 16. Bryn Erin Kelmar Avenue Basin
 17. Aston Woods
 18. Wyckfield Subdivision
 19. Rubino Property
- PUBLIC SCHOOL SITES**
20. K.D. Markley Elementary School
 21. Great Valley High School and Middle School
 22. School-Owned Property
- MAJOR PRIVATE SITES**
23. Chester Valley Golf Club
 24. Great Valley Little League Field
 25. Immaculata College/Convent
 26. Siemens Fields
 27. Liberty Property Fields
 28. Pickford Run (leased by School District)
- COUNTY - OWNED SITES**
29. Chester Valley Trail

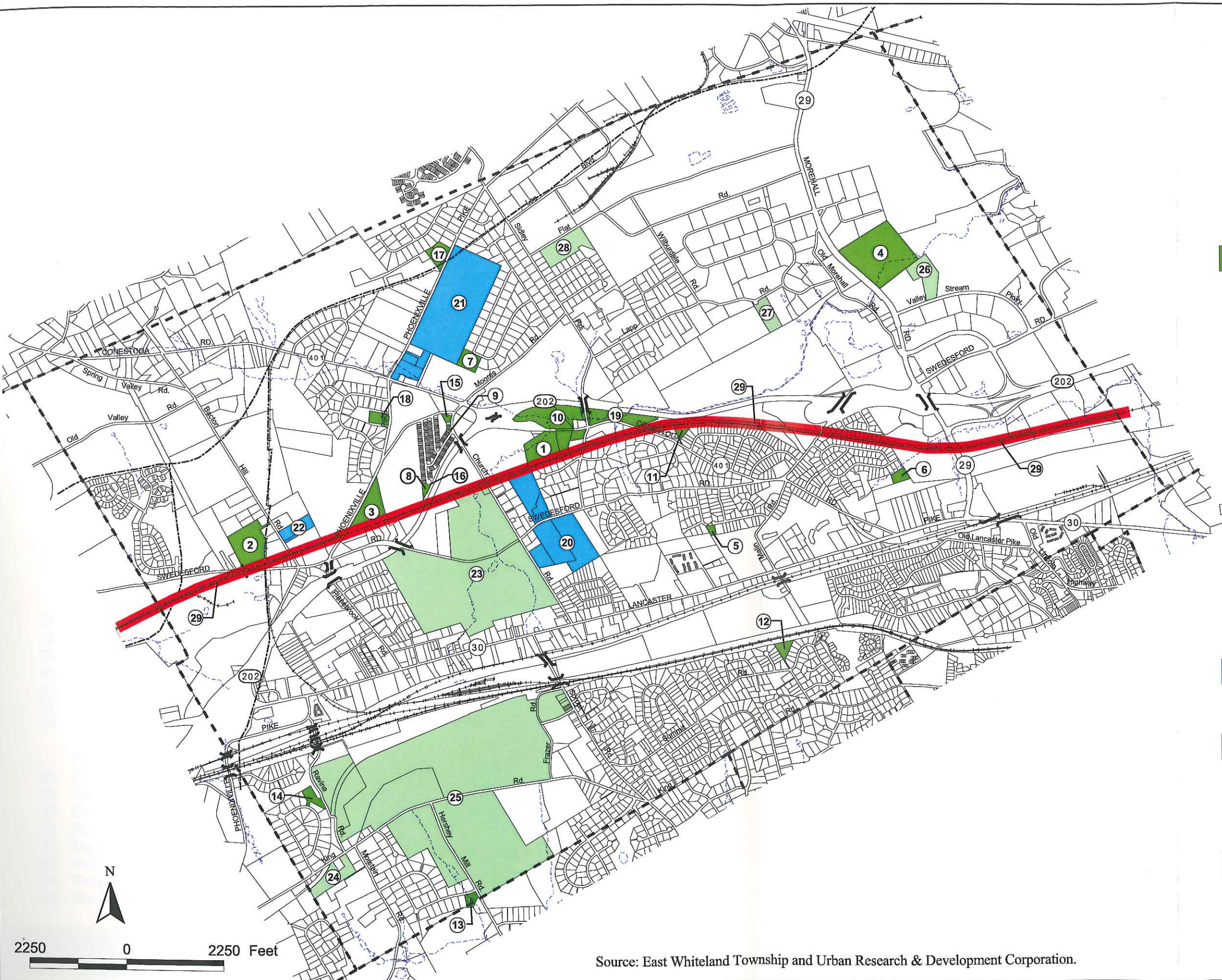

Source: East Whiteland Township and Urban Research & Development Corporation.

Tredyffrin Township Parks, Recreation and Open Space Plan

Existing Recreation Sites and Preserved Open Spaces

Map 8

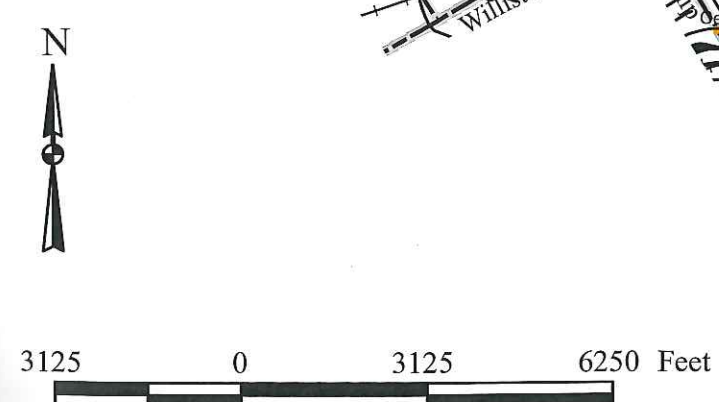
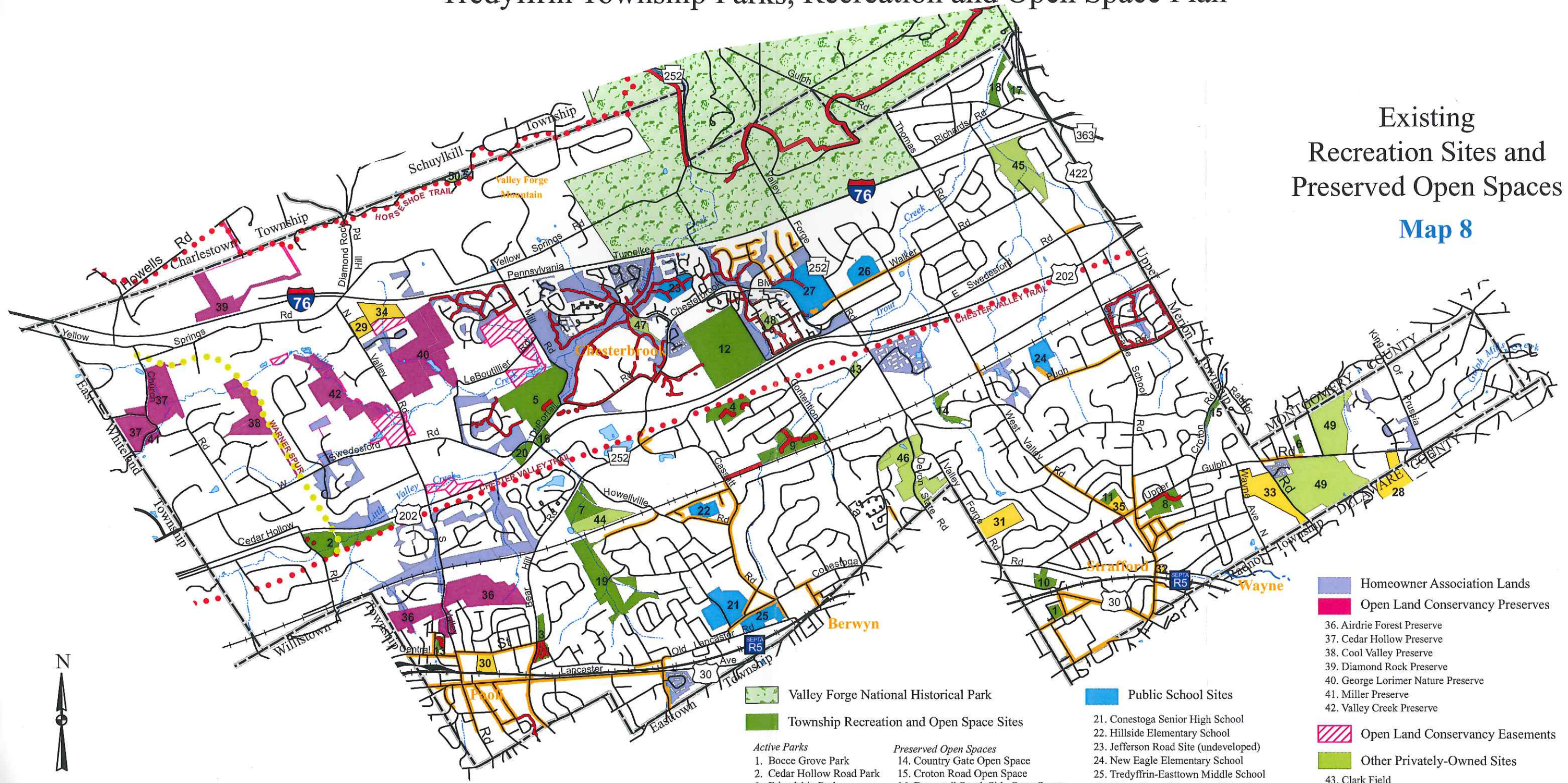

- Valley Forge National Historical Park
 - Township Recreation and Open Space Sites
 - Public School Sites
 - Private School Sites
 - Homeowner Association Lands
 - Open Land Conservancy Preserves
 - Open Land Conservancy Easements
 - Other Privately-Owned Sites
 - Regional Trails
 - Local Pathways
 - Sidewalks
- Active Parks**
1. Bocce Grove Park
 2. Cedar Hollow Road Park
 3. Friendship Park
 4. Louis D'Ambrosia Park
 5. Mill road Park
 6. Mazie B. Hall Park
 7. Radbill Park
 8. Strafford Park and Library
 9. Teegarden Park
 10. Westover Park (undeveloped)
 11. West Valley Park
 12. Wilson Farm Park
 13. Woodbine Park
- Preserved Open Spaces**
14. Country Gate Open Space
 15. Croton Road Open Space
 16. Duportail South Side Open Space
 17. Glenn Circle Open Space
 18. Richards Road Open Space
 19. Crabby Creek Park
 20. Swedesford Road Open Space
- Trails**
- Warner Spur Right-of-Way (a proposed trail)
- Public School Sites**
21. Conestoga Senior High School
 22. Hillside Elementary School
 23. Jefferson Road Site (undeveloped)
 24. New Eagle Elementary School
 25. Tredyffrin-Easttown Middle School
 26. Valley Forge Elementary School
 27. Valley Forge Middle School
- Private School Sites**
28. Cabrini College
 29. Crossroads School
 30. Delaware Valley Friends School
 31. Devon Preparatory School
 32. The Goddard School
 33. Valley Forge Military Academy
 34. Vanguard School
 35. Woodlynde School
- Other Privately-Owned Sites**
36. Airdrie Forest Preserve
 37. Cedar Hollow Preserve
 38. Cool Valley Preserve
 39. Diamond Rock Preserve
 40. George Lorimer Nature Preserve
 41. Miller Preserve
 42. Valley Creek Preserve
 43. Clark Field
 44. Field of Dreams
 45. Glenhardie Country Club
 46. Jenkins Arboretum
 47. Picket Post Swim & Tennis Club - Bradford Road site
 48. Picket Post Swim & Tennis Club - Chase Road site
 49. St. Davids Golf Club
 50. Valley Forge Mountain Racquet Club
 51. Valley Forge Mountain Association Park

Sources: Tredyffrin Township, Chester County DCIS, and URDC



0 1,000 2,000 Feet



Urban Research & Development Corporation
28 West Broad Street Bethlehem, Pennsylvania 18018 610-865-0701